



## KEY FEATURES

- ▶ **Stylish Industrial Design:** Features a matte black finish with a distinctive honeycomb mesh surface, transforming the traditional style of fixed gas outdoor heaters
- ▶ **High Heating Capacity:** Available in 25 MJ and 42 MJ models, effectively warming outdoor areas up to 20 m<sup>2</sup>
- ▶ **Durable Construction:** Built with premium materials ensuring longevity and reliability
- ▶ **Pivot Arm Bracket:** For greater directional control of the heater making it easy to adjust the flow of heat, so radiant heat is delivered where it's needed

## MODEL OPTIONS



300

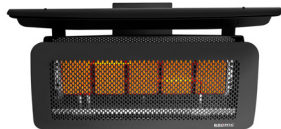

500

## MOUNTING OPTIONS



Wall Mounted



Ceiling Mounted

## DIMENSIONS

FRONT PROFILE (WITH HEAT DEFLECTOR)

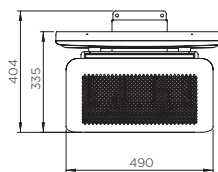

300

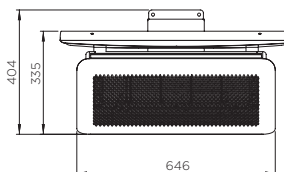

500

SIDE PROFILE (WITH HEAT DEFLECTOR)

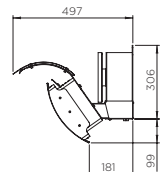

FRONT PROFILE (WITHOUT HEAT DEFLECTOR)

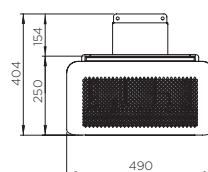

300

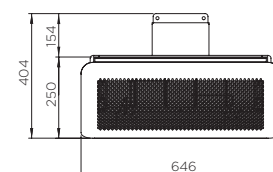

500

SIDE PROFILE (WITHOUT HEAT DEFLECTOR)

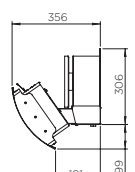

Discover more about *Tungsten Smart-Heat™ Gas*

Learn more at [bromic.com](http://bromic.com)

## SPECIFICATIONS

PRODUCT NUMBER	MODEL	FUEL SOURCE	HEAT AREA	WEIGHT	RATED CURRENT	MINIMUM FLOOR CLEARANCE	APPROVAL CERTIFICATION	IP RATING	CONTROL OPTIONS
2620331-1   2620330-1	300	NG & LPG	12m <sup>2</sup>	15kgs.	220-240V/2A	2500mm	Global Mark GAS-100177-002	IPX4	Affinity On/Off Manual Wall Switch
2620341-1   2620340-1	500	NG & LPG	20m <sup>2</sup>	20kgs.	220-240V/2A				

\* In ideal conditions

## CLEARANCES

### INCLUDED MOUNT

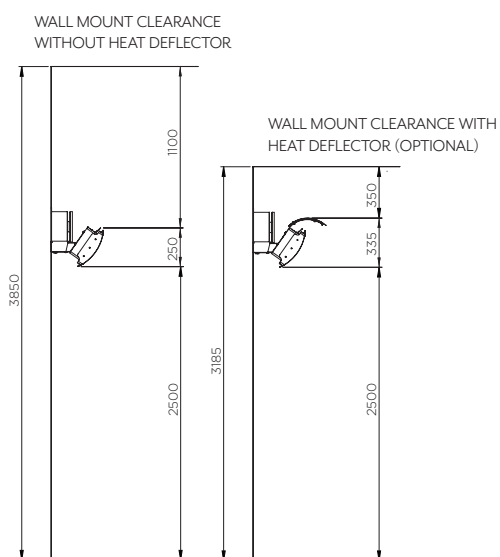

### MOUNTING ACCESSORIES

(AVAILABLE IN 246mm, 446mm, 646mm, 846mm AND 1046mm)

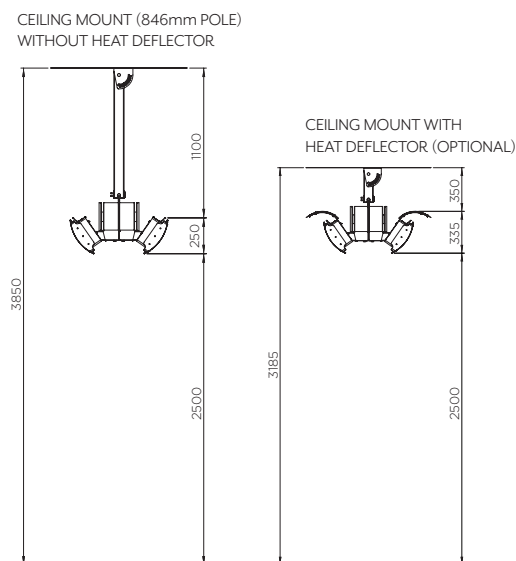

### WALL BRACKET

